



BUCKEYE BUILDS THE HOME,  
YOU BUILD THE MEMORIES.



Tami Emans

Email: [tamiemans@gmail.com](mailto:tamiemans@gmail.com)

Cell: 419.377.0734

**Square Footage:**

Total	1955
Garage	642

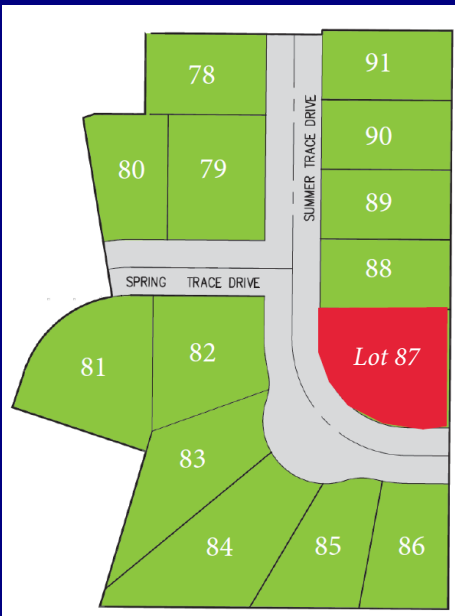

# 26352 Summer Trace Dr.

Perrysburg, Ohio

Eckel Trace Subdivision

Lot 87 Aspen Elite Floor Plan List Price: \$324,900

- Three Bedrooms and Two Full Baths
- Laundry Room with Utility Tub
- Open Concept Floor Plan
- Spacious Kitchen with Pantry
- Gas Fireplace with Custom Built Wood Mantle
- Beautiful Hardwood Floors
- Stainless Steel Appliances
- 1 Year Home Builders Association Warranty
- Tile Flooring in Bathrooms and Laundry
- 2 Car Garage with Extra Storage Area
- High Efficiency Furnace and Air Conditioning
- Granite Kitchen Countertops with Tile Backsplash



*Buckeye Builds The Home, You Build The Memories...*

First Floor

